

**ULINE** S-12896, S-12897  
S-12898  
**BUBBLE CORNER  
GUARDS**

1-800-295-5510  
uline.com

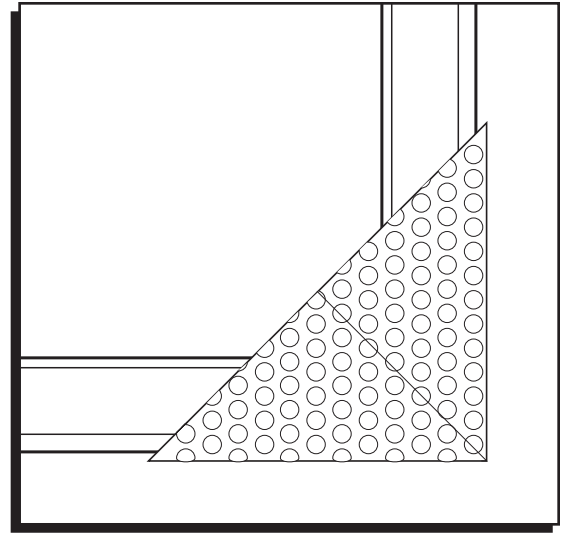

## INSTRUCTIONS

1. Tear bubble corner guard off the roll at the perforation. Grasp at the sealed edge. (See Figure 1)

Figure 1

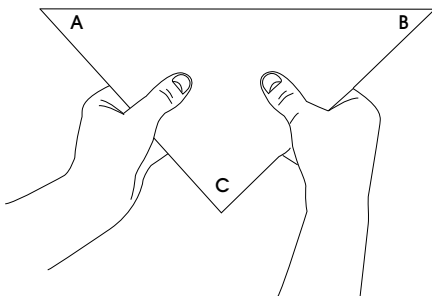

2. Press sealed edges inward to open the corner guard. (See Figure 2)

Figure 2

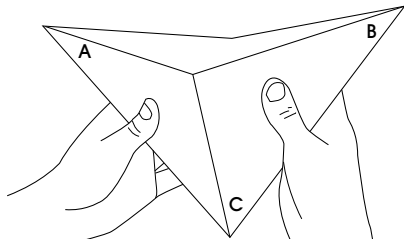

3. Fold points A and B into the corner guard until they touch point C. (See Figure 3)

Figure 3

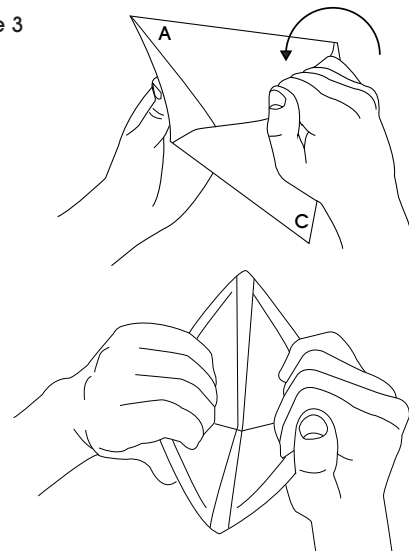

4. Apply to corner with seal seam on front and back of corner. (See Figure 4)

Figure 4

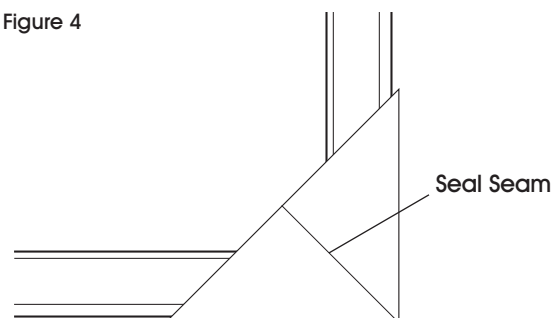

# ESQUINEROS DE BURBUJA PARA PROTECCIÓN

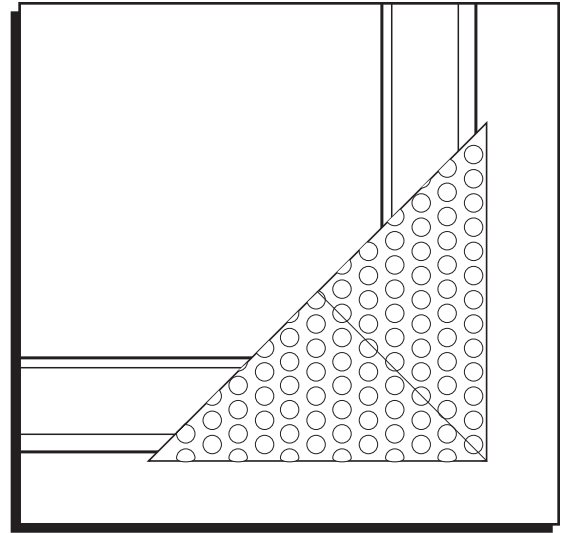

## INSTRUCCIONES

1. Arranque esquinero de burbuja para protección del rollo por la línea perforada. Sosténgalo por el borde sellado. (Vea Diagrama 1)

Diagrama 1

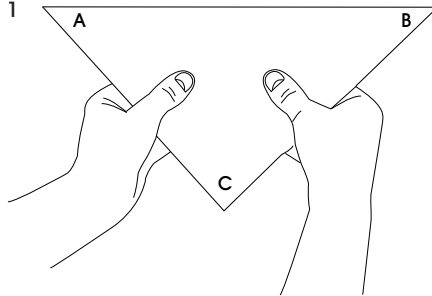

2. Presione los bordes sellados hacia adentro para abrir el esquinero. (Vea Diagrama 2)

Diagrama 2

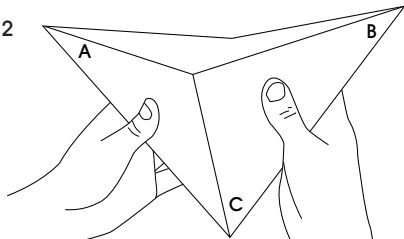

3. Doble los puntos A y B hacia adentro del esquinero hasta que toquen el punto C. (Vea Diagrama 3)

Diagrama 3

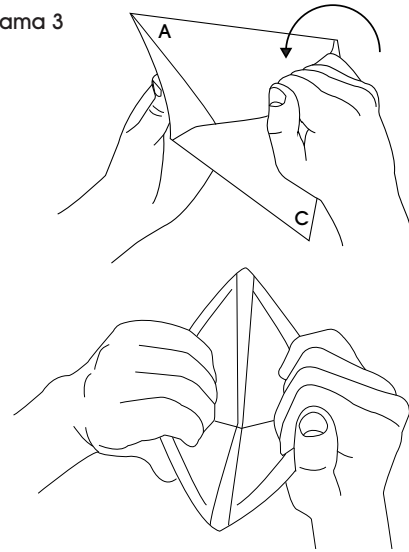

4. Colóquelo en la esquina con la costura sellada delante y detrás de la esquina. (Vea Diagrama 4)

Diagrama 4

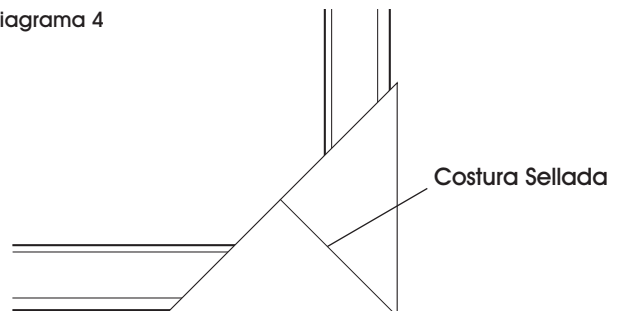

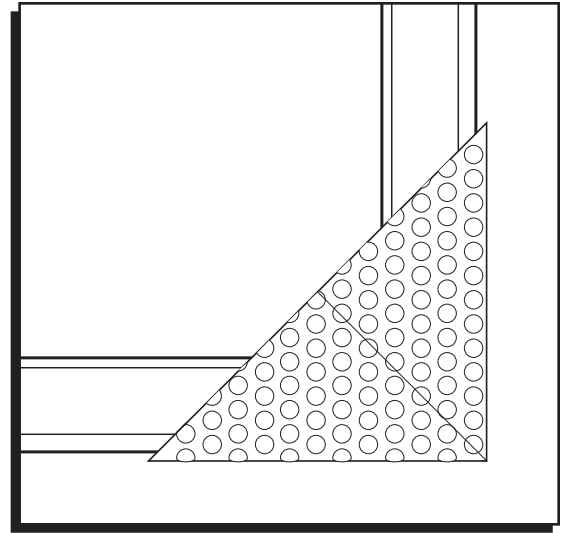

## INSTRUCTIONS

1. Retirez le protecteur de coins à bulles du rouleau à la ligne perforée. Saisissez-le par le bord scellé. (Voir Figure 1)

Figure 1

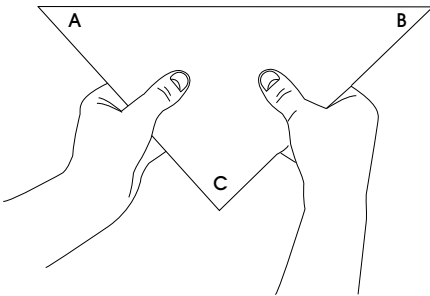

2. Poussez les bords scellés vers l'intérieur pour ouvrir le protecteur de coins. (Voir Figure 2)

Figure 2

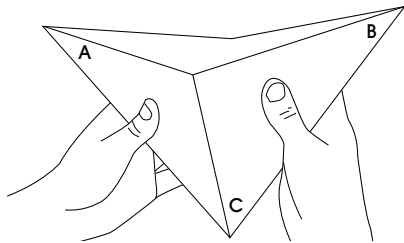

3. Pliez les points A et B vers l'intérieur du protecteur de coins jusqu'à ce qu'ils touchent le point C. (Voir Figure 3)

Figure 3

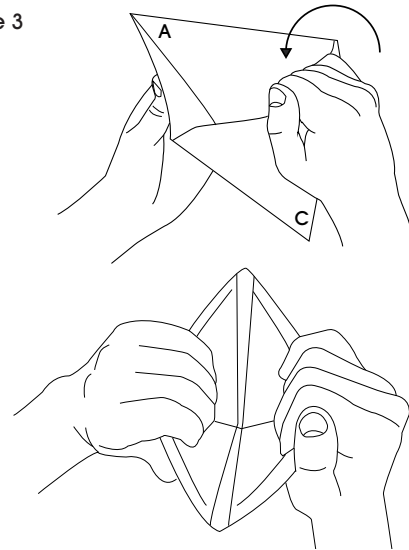

4. Placez-le protecteur sur le coin de telle façon que la pliure se retrouve à l'avant et à l'arrière du coin. (Voir Figure 4)

Figure 4

