

# ULINE H-6313 ELECTRONIC STORAGE CABINET

1-800-295-5510  
 uline.com

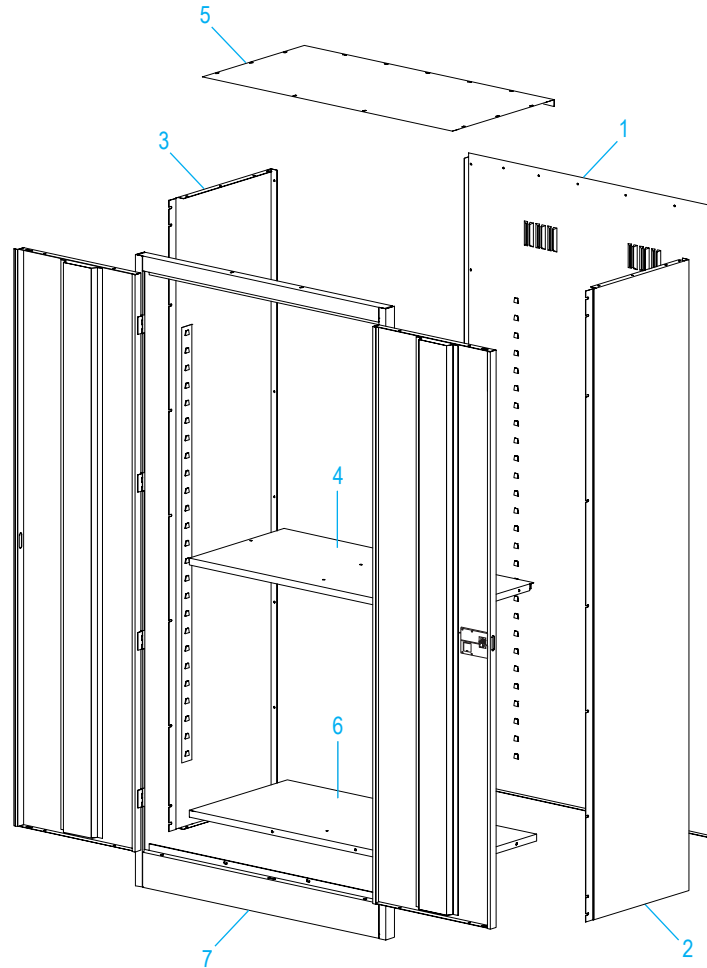
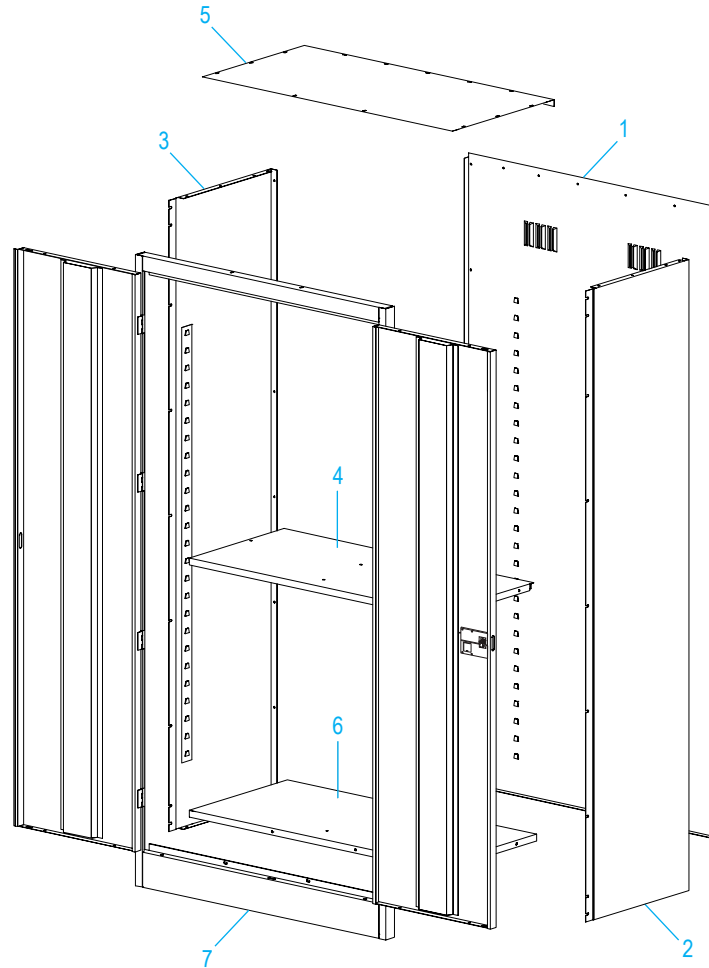

| # | DESCRIPTION  | QTY. | ULINE PART NO. | MFG. PART NO. |
|---|--|------|----------------|---------------|
| 1 | Back   | 1    | H-1223GR-BP    | 043BA-GRAY    |
| 2 | Right Side Panel   | 1    | -----          | 044RS-GRAY    |
| 3 | Left Side Panel  | 1    | -----          | 044LS-GRAY    |
| 4 | Shelf  | 4    | H-1223ADD-GR   | 302-GRAY      |
| 5 | Top  | 1    | -----          | 044TO-GRAY    |
| 6 | Bottom   | 1    | -----          | 044BO-GRAY    |
| 7 | Door and Frame Assembly  | 1    | -----          | -----         |
|   | #8-32 x 3/8" Bolt (Not Shown)  | 31   | -----          | -----         |
|   | #8-32 Nut (Not Shown)  | 47   | -----          | -----         |
|   | <b>Replacement Hardware Pack (Not Included)</b><br>Includes:<br>• #8-32 x 3/8" Bolt (72)<br>• #8-32 Nut (72) | 1    | H-1224-19      | HW-72         |

**ULINE H-6313****GABINETE ELECTRÓNICO  
PARA ALMACENAMIENTO**01-800-295-5510  
uline.mx

| # | DESCRIPCIÓN  | CANT. | NO. DE PARTE DE ULINE | NO. DE PARTE DEL FABRICANTE |
|---|--|-------|-----------------------|-----------------------------|
| 1 | Dorso  | 1     | H-1223GR-BP           | 043BA-GRAY                  |
| 2 | Panel Lateral Derecho  | 1     | -----                 | 044RS-GRAY                  |
| 3 | Panel Lateral Izquierdo  | 1     | -----                 | 044LS-GRAY                  |
| 4 | Repisa   | 4     | H-1223ADD-GR          | 302-GRAY                    |
| 5 | Parte Superior   | 1     | -----                 | 044TO-GRAY                  |
| 6 | Parte Inferior   | 1     | -----                 | 044BO-GRAY                  |
| 7 | Ensamble del Marco y de la Puerta  | 1     | -----                 | -----                       |
|   | Perno #8-32 x 3/8" (No Se Muestra)   | 31    | -----                 | -----                       |
|   | Tuerca #8-32 (No Se Muestra)   | 47    | -----                 | -----                       |
|   | <b>Paquete de Reemplazo de Tornillería (No Incluida)</b><br>Incluye:<br>• Perno #8-32 x 3/8" (72)<br>• Tuerca #8-32 (72) | 1     | H-1224-19             | HW-72                       |

**ULINE** H-6313**ARMOIRE D'ENTREPOSAGE  
ÉLECTRONIQUE**

1-800-295-5510

uline.ca

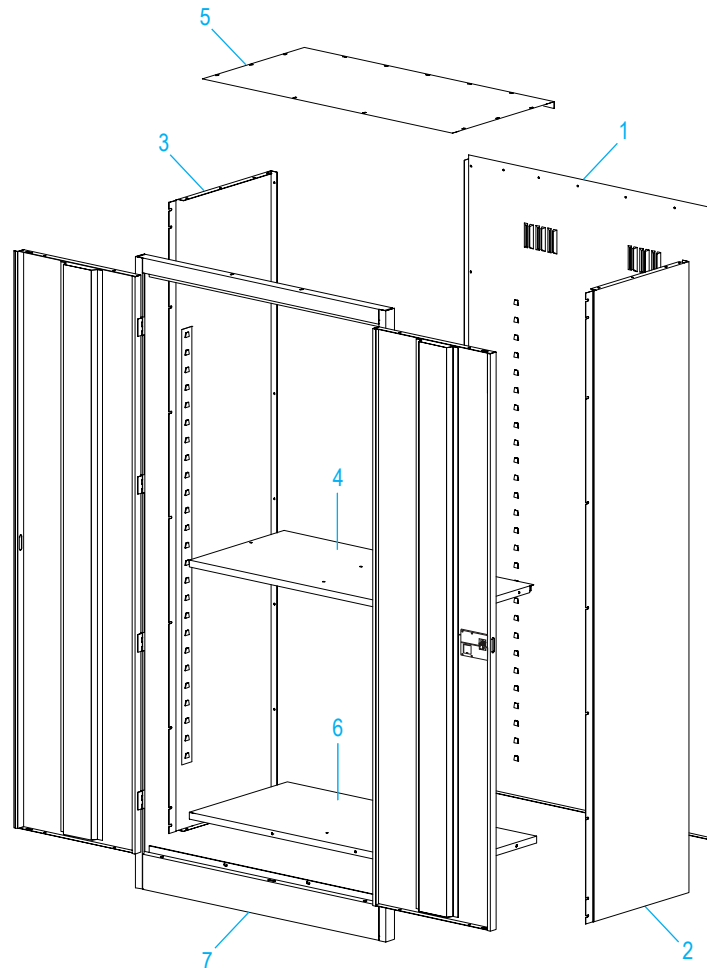
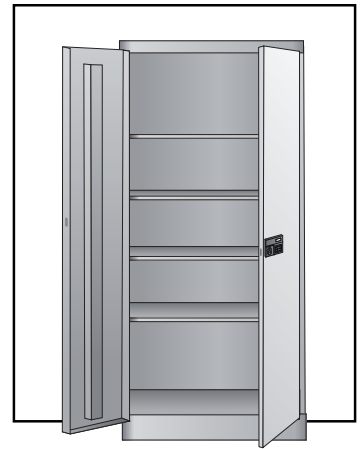

| # | DESCRIPTION   | QTÉ | RÉF. ULINE   | RÉF. DU FABRICANT |
|---|---|-----|--------------|-------------------|
| 1 | Panneau arrière   | 1   | H-1223GR-BP  | 043BA-GRAY        |
| 2 | Panneau latéral droit   | 1   | -----        | 044RS-GRAY        |
| 3 | Panneau latéral gauche  | 1   | -----        | 044LS-GRAY        |
| 4 | Tablette  | 4   | H-1223ADD-GR | 302-GRAY          |
| 5 | Panneau supérieur   | 1   | -----        | 044TO-GRAY        |
| 6 | Panneau inférieur   | 1   | -----        | 044BO-GRAY        |
| 7 | Ensemble de la porte et du cadre  | 1   | -----        | -----             |
|   | Boulon n° 8-32 x 3/8 po (non illustré)  | 31  | -----        | -----             |
|   | Écrou n° 8-32 (non illustré)  | 47  | -----        | -----             |
|   | <b>Sachet de matériel d'installation de remplacement (non inclus)</b><br>comprend :<br>• Boulon n° 8-32 x 3/8 po (72)<br>• Écrou n° 8-32 (72) | 1   | H-1224-19    | HW-72             |